

JARUP

Axle and Trailer Technology









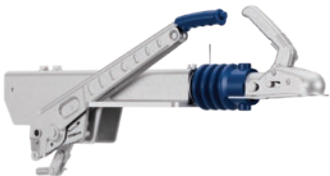

JARUP

JARUP is an engineering and manufacturing brand specializing in axle and trailer technologies, built upon a strong foundation of industry experience dating back to 2009. Operating from its production facility in Türkiye, JARUP delivers high-quality solutions tailored to the safety, strength, and durability requirements of the caravan and trailer industries.

Thanks to its full compliance with international certifications and its rigorous quality control processes, JARUP has become one of the most trusted brands in the sector, offering solutions that ensure maximum safety, superior durability, and long service life. Our range of braking systems and axle products is developed to deliver high performance, compatibility, and sustainable manufacturing standards across various application scenarios.

Our vision is to stand out in the global market with innovative, durable, and reliable products, while serving as a strong engineering partner that adds value to manufacturers not only today, but also in the future. With its continuously expanding customer network, increasing production capacity, and growing engineering expertise, JARUP continues to represent trust and stability within the industry.

OVERRUN DEVICES		2
COUPLING HEADS		3
GALVANIZED BRAKED AXLES		4
REINFORCED BRAKED AXLES		6
ZINC BRAKED AXLES		8
UNBRAKED AXLES		9
JOCKEY WHEELS		13
WHEEL RIM AND WHEELS		14
CHASSIS SETS		16

OVERRUN DEVICES

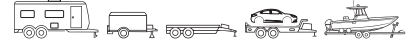

The overrun devices is an important component that makes the connection between your trailer and caravan safer and more controlled. This system enhances the safety of your trailer and caravan, providing greater control during your journeys, and ensures that the caravan stays securely attached to the tow vehicle during emergency braking situations.

Quick and Effective Braking: The overrun devices integrates your trailer and caravan's braking system with the tow vehicle. This ensures that when the brakes are applied, the trailer and caravan's speed decreases in sync with the tow vehicle. As a result, the risk of the caravan or trailer swerving or placing additional load on the tow vehicle is reduced, allowing both vehicles to stop in a more controlled manner.

High Security: The overrun devices enhances safety, especially during long journeys and in heavy traffic. By strengthening the connection between the tow vehicle and the trailer or caravan, it ensures that both vehicles move more steadily in the event of sudden situations.

Less Vibrations: The overrun devices minimizes the trailer and caravan's movement and vibrations, offering a more stable driving experience, especially on turns and downhill descents. This ensures that your trailer and caravan moves more steadily on the road and provides a more comfortable experience during your journey.

Long Lifespan and Durability: The overrun devices, made from high-quality materials, is designed for long-term use and performs excellently even under harsh road conditions. It ensures a secure and strong connection between the tow vehicle and the trailer or caravan.

OVERRUN DEVICE | 2700 Kg



Technical Specifications

Model	: JRO80270
Vertical Static Load	: 1177 N (\approx 120 Kg)
Load Capacity	: 2700 Kg
Connection Dimensions:	1200 mm
Product Weight	: \sim 22.0 Kg

Code JROVD-2700-G

OVERRUN DEVICE | 900 - 1600 Kg

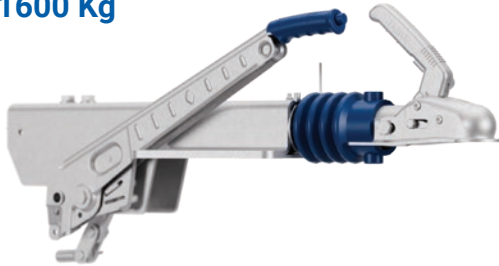

Technical Specifications

Model	: JRO80200
Vertical Static Load	: 1000 N (\approx 100 Kg)
Load Capacity	: 900 – 1600 Kg
Connection Dimensions:	1200 mm
Product Weight	: \sim 13.0 Kg

Code JROVD-900-1600-G

OVERRUN DEVICE | 600 - 1050 Kg

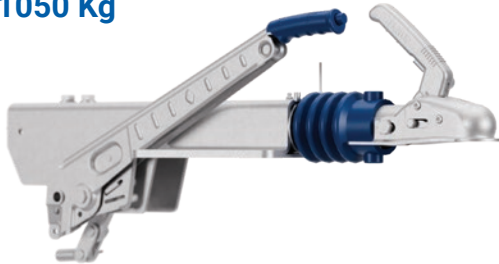

Technical Specifications

Model	: JRB0525
Vertical Static Load	: 1000 N (\approx 100 Kg)
Load Capacity	: 600 - 1050 Kg
Connection Dimensions:	1200 mm
Product Weight	: \sim 11.0 Kg

Code JROVD-600-1050-G

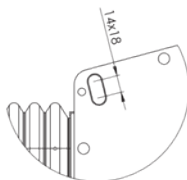
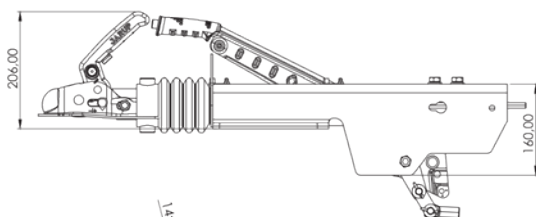

DETAIL A
SCALE 1 : 3

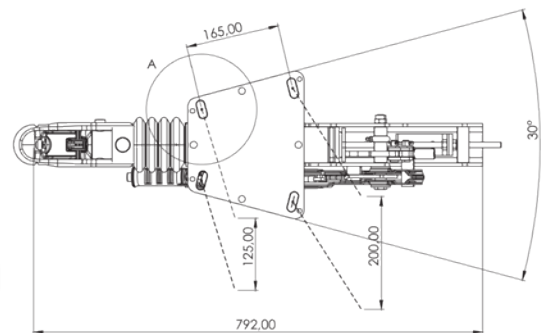
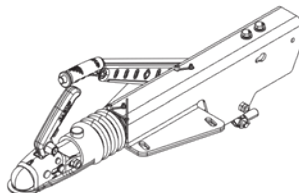

COUPLING HEADS

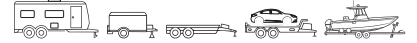

COUPLING HEAD | 1400 Kg



Technical Specifications

Model	: JRCH-50-1400-SQ-G
Mounting Size	: 50x50 mm
Load Capacity	: 1400 Kg
Mounting Type	: 2xVertical Bolt Connection
Bolt Size	: M12 / M12
Max. Support Load	: 85 Kg
Product Weight	: ~ 2.0 Kg
Ball Bearing Standard	: 50 mm

Code JRCH-50-1400-SQ-G

COUPLING HEAD | 1000 Kg



Technical Specifications

Model	: JRCH-50-1000-SQ-G
Mounting Size	: 50x50 mm
Load Capacity	: 1000 Kg
Mounting Type	: 2xVertical Bolt Connection
Bolt Size	: M12 / M12
Max. Support Load	: 85 Kg
Product Weight	: ~ 1.6 Kg
Ball Bearing Standard	: 50 mm

Code JROVD-600-1050-G

COUPLING HEAD | 750 Kg



Technical Specifications

Model	: JRCH-50-750
Mounting Size	: 50x50 mm
Load Capacity	: 750 Kg
Mounting Type	: 2xVertical Bolt Connection
Bolt Size	: M12 / M12
Max. Support Load	: 75 Kg
Product Weight	: ~ 1.4 Kg
Ball Bearing Standard	: 50 mm

Code JRCH-50-750-SQ-G

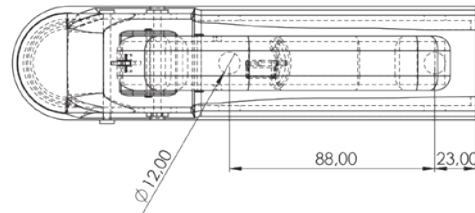
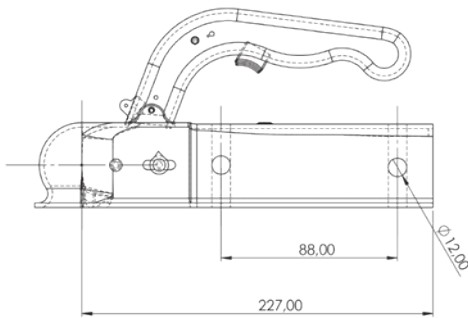

COUPLING HEAD | 1400 Kg (ROUND DRAWBAR)

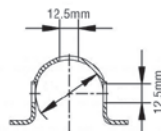
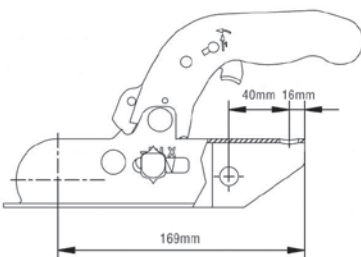

Technical Specifications

Model	: JRCH-50-1400-SQ-G
Mounting Size	: 50x50 mm
Load Capacity	: 1400 Kg
Mounting Type	: Round Mounting
Bolt Size	: M12 / M12
Max. Support Load	: 100 Kg
Product Weight	: ~ 1.2 Kg
Ball Bearing Standard	: 50 mm

Code JRCH-R-1600-G

GALVANIZED BRAKED AXLE | 1050 Kg



Technical Specifications

Model	: JRB075012
Total Load Capacity	: 1050 Kg
Flange to Flange (F)	: 1850 mm
Connection (C)	: 1400 mm
Product Weight	: ~ 56.0 Kg

Code JRBA-1050-G

GALVANIZED BRAKED AXLE | 750 Kg



Technical Specifications

Model	: JRB075012
Total Load Capacity	: 750 Kg
Flange to Flange (F)	: 1850 mm
Connection (C)	: 1400 mm
Product Weight	: ~56.0 Kg

Code JRBA-750-G

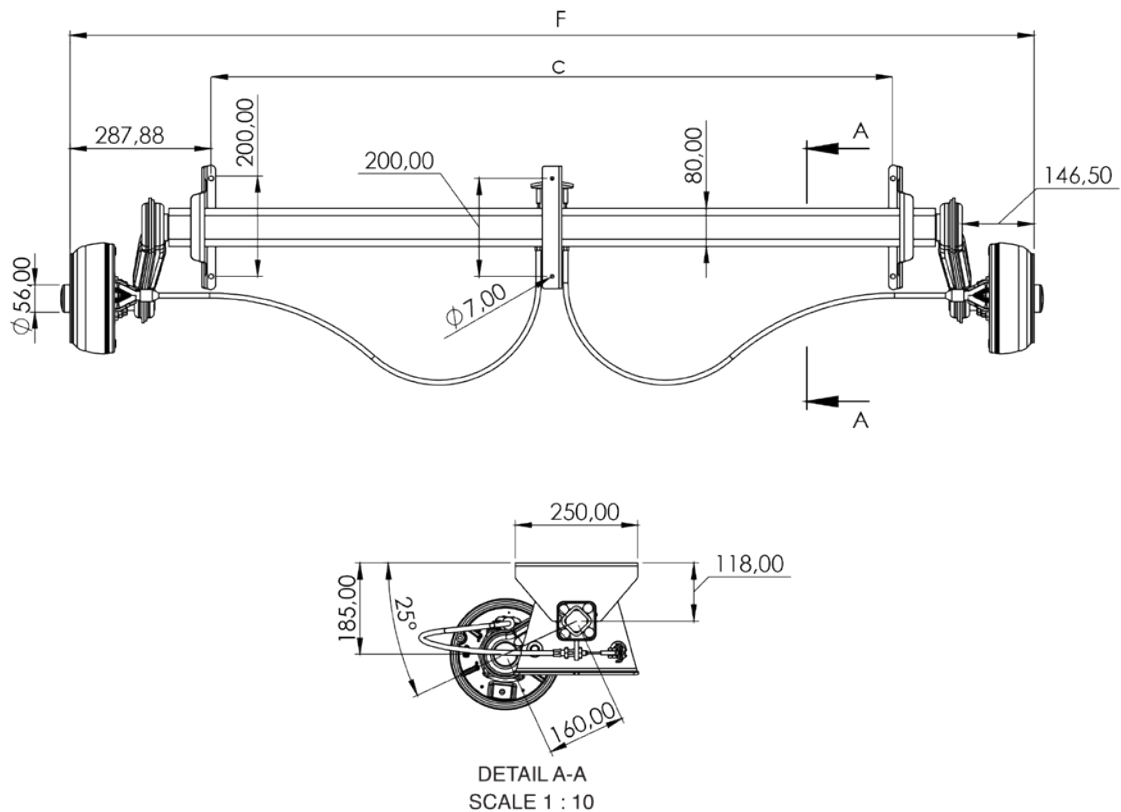

REINFORCED BRAKED AXLES



Reinforced braked axles have been developed to deliver maximum safety, durability, and performance by transferring the high technology of the automotive industry to the trailer and caravan sector. Manufactured using high-strength materials and advanced production techniques, these axles provide superior stability and long service life even under heavy load conditions.

Thanks to their reinforced structure, they offer extra resistance against challenging road and climate conditions. Designed with a precision engineering approach, our products reduce maintenance requirements and help lower operating costs.

Reinforced braked axles bring the high technology of the automotive industry to you, combining safety, strength, and performance in a single solution.

REINFORCED BRAKED AXLE | 1500 Kg



Technical Specifications

Model	: JRB075012
Total Load Capacity	: 1500 Kg
Flange to Flange (F)	: 1850 mm
Connection (C)	: 1400 mm
Product Weight	: ~56.0 Kg

Code JRBA-1500-B

REINFORCED BRAKED AXLE | 1500 Kg



Technical Specifications

Model	: JRB075012
Total Load Capacity	: 1500 Kg
Flange to Flange (F)	: 2070 mm
Connection (C)	: 1400 mm
Product Weight	: ~ 56.0 Kg

Code JRBA-1500-B-2070

REINFORCED BRAKED AXLE | 1350 Kg



Technical Specifications

Model	: JRB075012
Total Load Capacity	: 1350 Kg
Flange to Flange (F)	: 1850 mm
Connection (C)	: 1400 mm
Product Weight	: ~56.0 Kg

Code JRBA-1350-B

REINFORCED BRAKED AXLE | 1050 Kg



Technical Specifications

Model	: JRB075012
Total Load Capacity	: 1050 Kg
Flange to Flange (F)	: 1850 mm
Connection (C)	: 1400 mm
Product Weight	: ~ 56.0 Kg

Code JRBA-1050-B

REINFORCED BRAKED AXLE | 750 Kg



Technical Specifications

Model	: JRB075012
Total Load Capacity	: 750 Kg
Flange to Flange (F)	: 1850 mm
Connection (C)	: 1400 mm
Product Weight	: ~ 56.0 Kg

Code JRBA-750-B

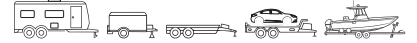

REINFORCED BRAKED AXLE | 1500 Kg



Technical Specifications

Model	: JRB075012
Total Load Capacity	: 1500 Kg
Flange to Flange (F)	: 1970 mm
Connection (C)	: 1400 mm
Product Weight	: ~56.0 Kg

Code JRBA-1500-G-1970

REINFORCED BRAKED AXLE | 1350 Kg



Technical Specifications

Model	: JRB075012
Total Load Capacity	: 1350 Kg
Flange to Flange (F)	: 1970 mm
Connection (C)	: 1400 mm
Product Weight	: ~ 56.0 Kg

Code JRBA-1350-G-1970

REINFORCED BRAKED AXLE | 1050 Kg



Technical Specifications

Model	: JRB075012
Total Load Capacity	: 1050 Kg
Flange to Flange (F)	: 1970 mm
Connection (C)	: 1400 mm
Product Weight	: ~ 56.0 Kg

Code JRBA-1050-G-1970

REINFORCED BRAKED AXLE | 750 Kg



Technical Specifications

Model	: JRB075012
Total Load Capacity	: 750 Kg
Flange to Flange (F)	: 1970 mm
Connection (C)	: 1400 mm
Product Weight	: ~ 56.0 Kg

Code JRBA-750-G-1970

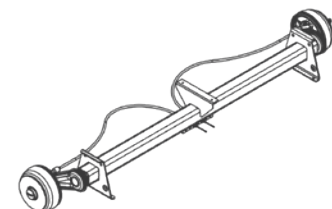
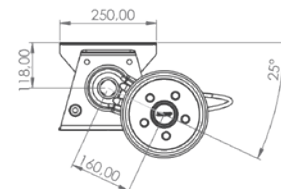
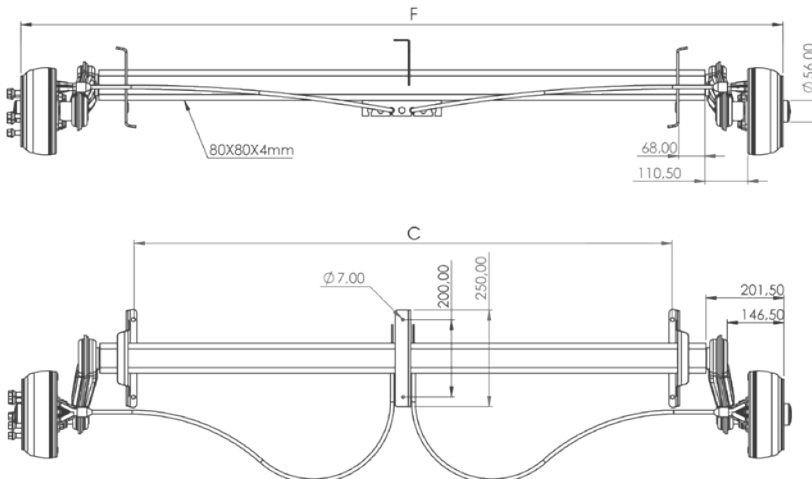

ZINC BRAKED AXLE | 1500 Kg



Model	: JRB075012
Total Load Capacity	: 1500 Kg
Flange to Flange (F)	: 1850 mm
Connection (C)	: 1400 mm
Product Weight	: ~56.0 KG

ZINC BRAKED AXLE | 1350 Kg



Model : JRB075012
Total Load Capacity : 1350 Kg
Flange to Flange (F) : 1850 mm
Connection (C) : 1400 mm
Product Weight : ~56.0 KG

ZINC BRAKED AXLE | 1050 Kg



Model	: JRB075012
Total Load Capacity	: 1050 Kg
Flange to Flange (F)	: 1850 mm
Connection (C)	: 1400 mm
Product Weight	: ~56.0 KG

ZINC BRAKED AXLE | 750 Kg



Model : JRB075012
Total Load Capacity : 750 Kg
Flange to Flange (F) : 1850 mm
Connection (C) : 1400 mm
Product Weight : ~56.0 KG

Code	JRBA-750-Z
-------------	-------------------

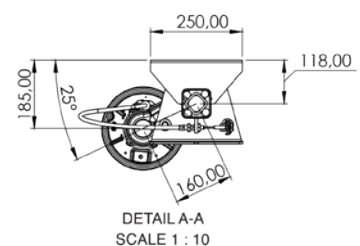
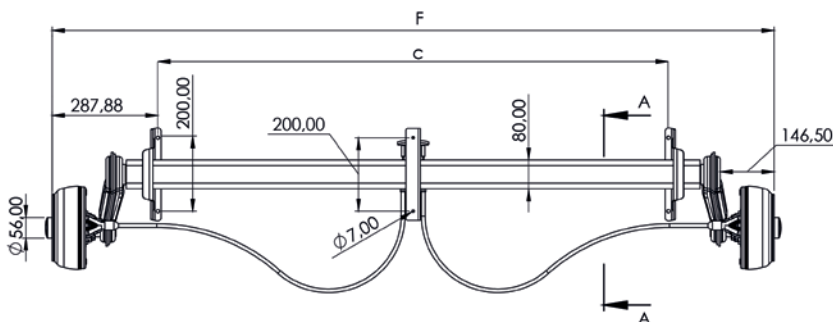

UNBRAKED AXLES

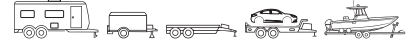

Unbraked axles are reliable and durable transport solutions designed for trailers and light transport vehicles that do not require a braking system. Thanks to their simple and robust structure, they offer long-lasting use in load-carrying applications.

High-strength unbraked axles provide stable performance in various road and load conditions. With low maintenance requirements and easy installation advantages, they are an ideal choice especially for light trailers, platforms, and special-purpose transport systems.

Manufactured in accordance with international quality standards, our unbraked axles are developed with the aim of ensuring safe driving and a long service life.

UNBRAKED AXLE | 750 Kg



Technical Specifications

Model	: JRUA-750
Total Load Capacity	: 750 Kg
Flange to Flange (F)	: 1650 mm
Connection (C)	: 1200 mm
Product Weight	: ~25.0 Kg

Code JRUA-750-G-120

UNBRAKED AXLE | 750 Kg



Technical Specifications

Model	: JRUA-750
Total Load Capacity	: 750 Kg
Flange to Flange (F)	: 1850 mm
Connection (C)	: 1400 mm
Product Weight	: ~25.0 Kg

Code JRUA-750-G-140

UNBRAKED AXLE | 750 Kg



Technical Specifications

Model	: JRUA-750
Total Load Capacity	: 750 Kg
Flange to Flange (F)	: 1950 mm
Connection (C)	: 1500 mm
Product Weight	: ~25.0 Kg

Code JRUA-750-G-150

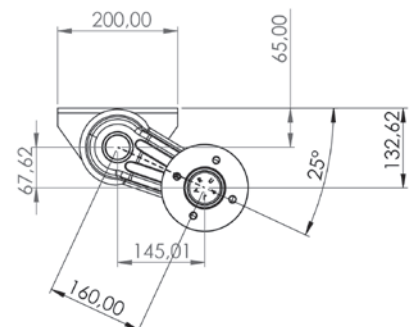

UNBRAKED AXLES

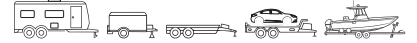

UNBRAKED AXLE | 750 Kg



Technical Specifications

Model	: JRUA-750
Total Load Capacity	: 750 Kg
Flange to Flange (F)	: 2050 mm
Connection (C)	: 1600 mm
Product Weight	: ~25.0 Kg

Code JRUA-750-G-160

UNBRAKED AXLE | 750 Kg



Technical Specifications

Model	: JRUA-750
Total Load Capacity	: 750 Kg
Flange to Flange (F)	: 2150 mm
Connection (C)	: 1700 mm
Product Weight	: ~25.0 Kg

Code JRUA-750-G-170

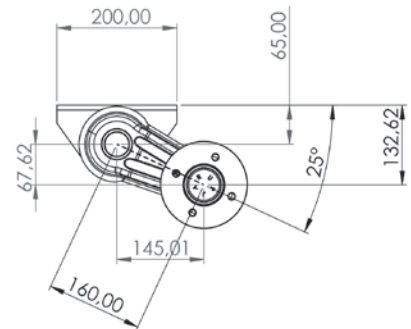

UNBRAKED AXLES

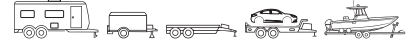

Unbraked axles are reliable and durable transport solutions designed for trailers and light transport vehicles that do not require a braking system. Thanks to their simple and robust structure, they offer long-lasting use in load-carrying applications.

High-strength unbraked axles provide stable performance in various road and load conditions. With low maintenance requirements and easy installation advantages, they are an ideal choice especially for light trailers, platforms, and special-purpose transport systems.

Manufactured in accordance with international quality standards, our unbraked axles are developed with the aim of ensuring safe driving and a long service life.

UNBRAKED AXLE | 1050 Kg



Technical Specifications

Model	: JRUA-1050
Total Load Capacity	: 1050 Kg
Flange to Flange (F)	: 1650 mm
Connection (C)	: 1200 mm
Product Weight	: ~25.0 Kg

Code JRUA-1050-G-120

UNBRAKED AXLE | 1050 Kg



Technical Specifications

Model	: JRUA-1050
Total Load Capacity	: 1050 Kg
Flange to Flange (F)	: 1850 mm
Connection (C)	: 1400 mm
Product Weight	: ~25.0 Kg

Code JRUA-1050-G-140

UNBRAKED AXLE | 1050 Kg



Technical Specifications

Model	: JRUA-1050
Total Load Capacity	: 1050 Kg
Flange to Flange (F)	: 1950 mm
Connection (C)	: 1500 mm
Product Weight	: ~25.0 Kg

Code JRUA-1050-G-150

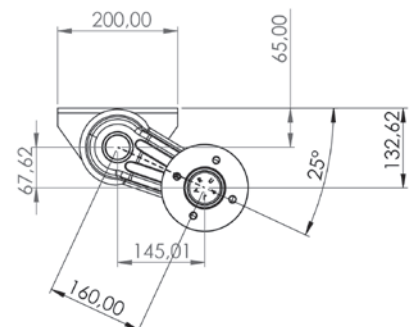

UNBRAKED AXLES



Unbraked axles are reliable and durable transport solutions designed for trailers and light transport vehicles that do not require a braking system. Thanks to their simple and robust structure, they offer long-lasting use in load-carrying applications.

High-strength unbraked axles provide stable performance in various road and load conditions. With low maintenance requirements and easy installation advantages, they are an ideal choice especially for light trailers, platforms, and special-purpose transport systems.

Manufactured in accordance with international quality standards, our unbraked axles are developed with the aim of ensuring safe driving and a long service life.

UNBRAKED AXLE | 1050 Kg



Technical Specifications

Model	: JRUA-1050
Total Load Capacity	: 1050 Kg
Flange to Flange (F)	: 2050 mm
Connection (C)	: 1600 mm
Product Weight	: ~25.0 Kg

Code	JRUA-1050-G-160
-------------	------------------------

UNBRAKED AXLE | 1050 Kg



Technical Specifications

Model	: JRUA-1050
Total Load Capacity	: 1050 Kg
Flange to Flange (F)	: 2150 mm
Connection (C)	: 1700 mm
Product Weight	: ~25.0 Kg

Code	JRUA-1050-G-170
-------------	------------------------

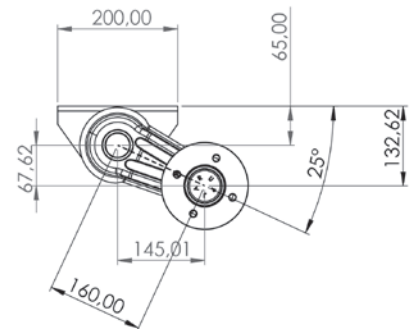

JOCKEY WHEELS

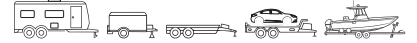

The jockey wheel provides great convenience when parking and moving your trailer or caravan. It is an indispensable piece of equipment for securing, moving, or safely lifting your trailer or caravan. With its durable structure and practical design, it assists you on every journey.

JOCKEY WHEEL



Technical Specifications

Model : JRJW-48
Type : Classic Model
Total Load Capacity : 150 Kg

Code JRJW-48-C

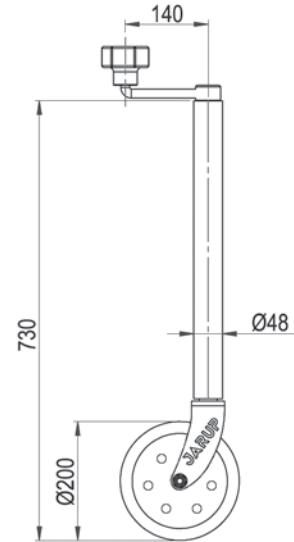

JOCKEY WHEEL



Technical Specifications

Model : JRJW-48
Type : Compact Model
Total Load Capacity : 150 Kg

Code JRJW-48-K

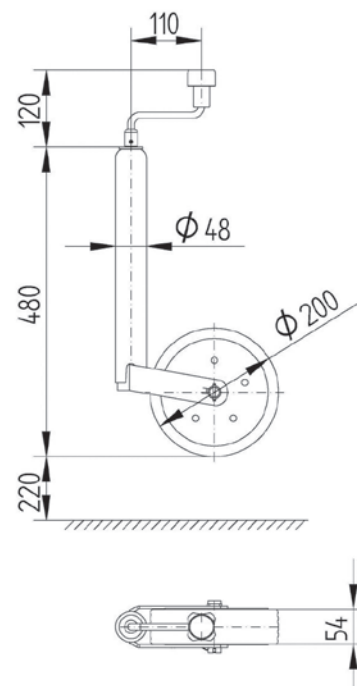

WHEEL



Technical Specifications

LT : 102/100
SS : T
Weight : 9,561 Kg
Size : 185R14
Load Capacity: 860 Kg

WHEEL RIM



Technical Specifications

Model : JRRM-14
Load Capacity : 850 Kg
Number of Bolts : 5
Loaded Speed Limit : 120 km/h
Material : Iron

Code	JRRM-14-ST-5
------	--------------

WHEEL RIM



Technical Specifications

Model : JRRM-14
Load Capacity : 700 Kg
Number of Bolts : 4
Loaded Speed Limit : 120 km/h
Material : Iron

Code	JRRM-14-ST-4
------	--------------

WHEEL RIM



Technical Specifications

Model	: JRRM-14
Load Capacity	: 700 Kg
Number of Bolts	: 4
Loaded Speed Limit	: 120 km/h
Material	: Aluminum Alloy

Code	JRRM-14-AL-4
-------------	---------------------

WHEEL RIM



Technical Specifications

Model	: JRRM-14
Load Capacity	: 1030 Kg
Number of Bolts	: 5
Loaded Speed Limit	: 120 km/h
Material	: Aluminum Alloy

Code	JRRM-14-AL-5
-------------	---------------------

THANKS TO JARUP'S INNOVATIVE EXPANDABLE CHASSIS SYSTEM, YOU CAN PRODUCE CARAVANS IN DIFFERENT SIZES WITH JUST ONE CHASSIS!

CHASSIS SET | 1500 Kg

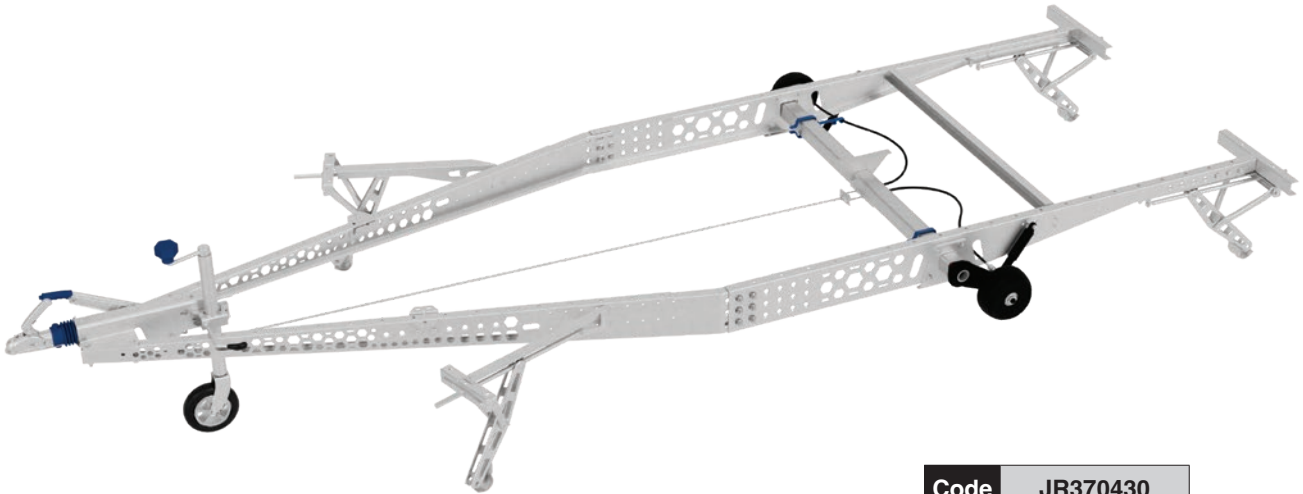

Code JR370430

JARUP chassis are designed with superior engineering and quality.

Every detail is meticulously calculated to ensure your safety when you hit the road. Made from durable materials, this chassis offers maximum safety and performance even in challenging road conditions.

- The expandable chassis system provides flexible usage advantages.
- No need to maintain different chassis stock for various caravan sizes.
- Maximum efficiency with minimal stock.
- Shortened chassis size: 4947 mm
- Extended chassis size: 5427 mm

Whether you're taking short or long trips, by choosing JARUP chassis, you ensure reliability and durability without compromise in any situation.

The JARUP axle is surrounded by 4 rubber elements instead of 3.

Why is 4 rubber elements important?

Load Distribution and Balance: Four rubber elements increase the load capacity, helping distribute the weight more evenly. This allows the caravan to move in a more balanced and stable manner. In particular, for larger caravans carrying heavy loads, this balance enhances safety during the journey.

Road Grip and Stability: More rubber improves the caravan's road grip. With more tires in contact with the ground, the risk of slipping or swerving is reduced, especially at high speeds or in challenging road conditions.

High Load Capacity: Four rubber elements can significantly increase the caravan's load capacity. This is especially important for larger caravans, as the large amount of equipment and belongings the caravan needs to carry can be managed more efficiently with additional axles.

Reduced Road Damage: The caravan's weight is distributed more evenly across the four rubber elements, resulting in less pressure on the road. This reduces damage to the road surface and minimizes deformation.

Suspension System: More rubber helps the suspension system work more effectively. This ensures the caravan moves more smoothly on the road and enhances driving comfort.

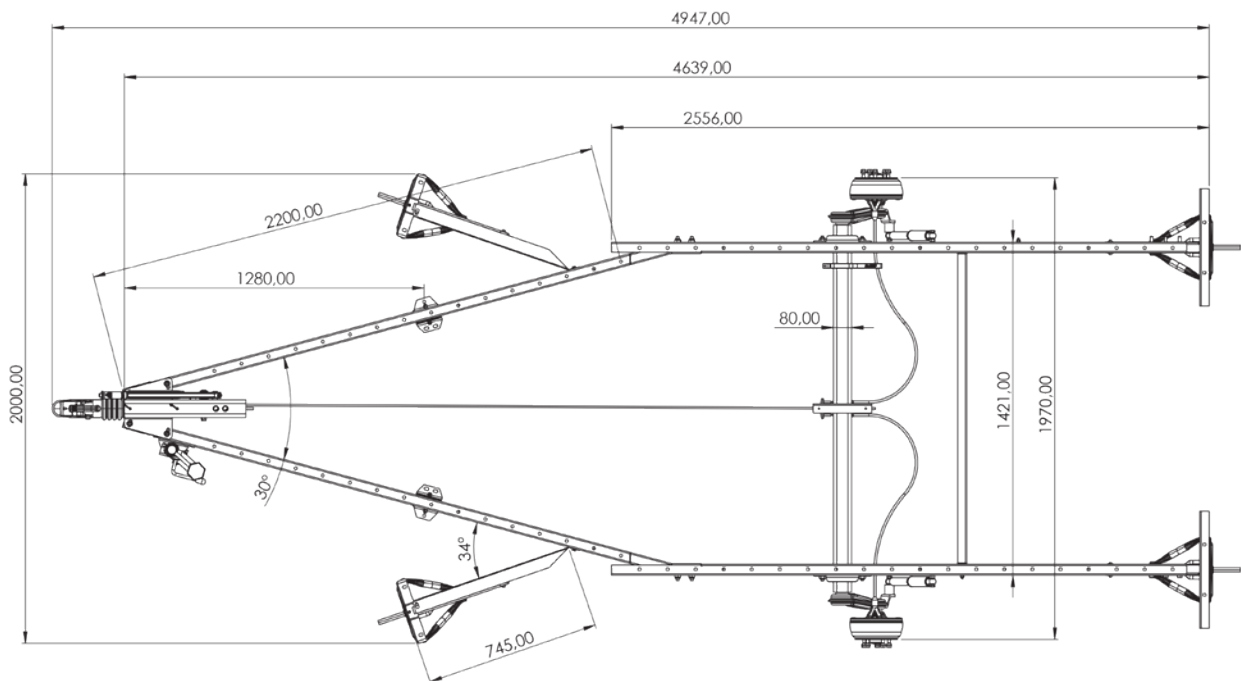

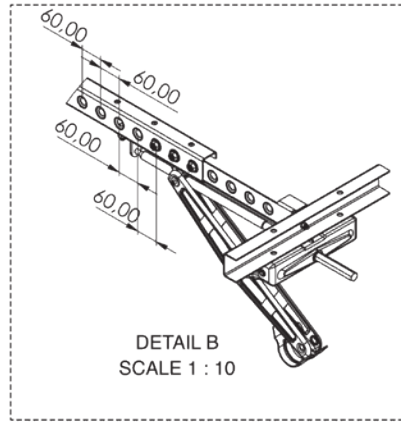
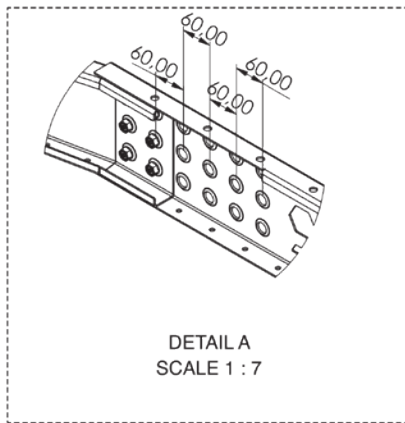
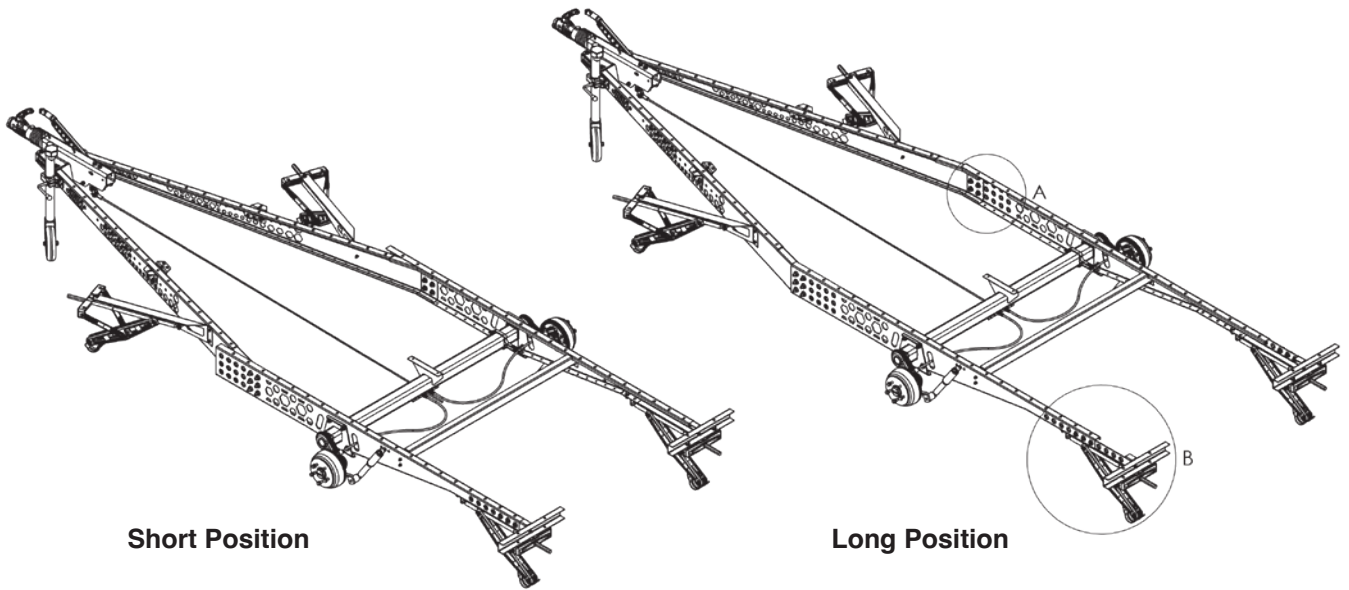

Note: The chassis can be extended by 240 mm at the front and 240 mm at the rear, with 60 mm increments, allowing a total extension of 480 mm.

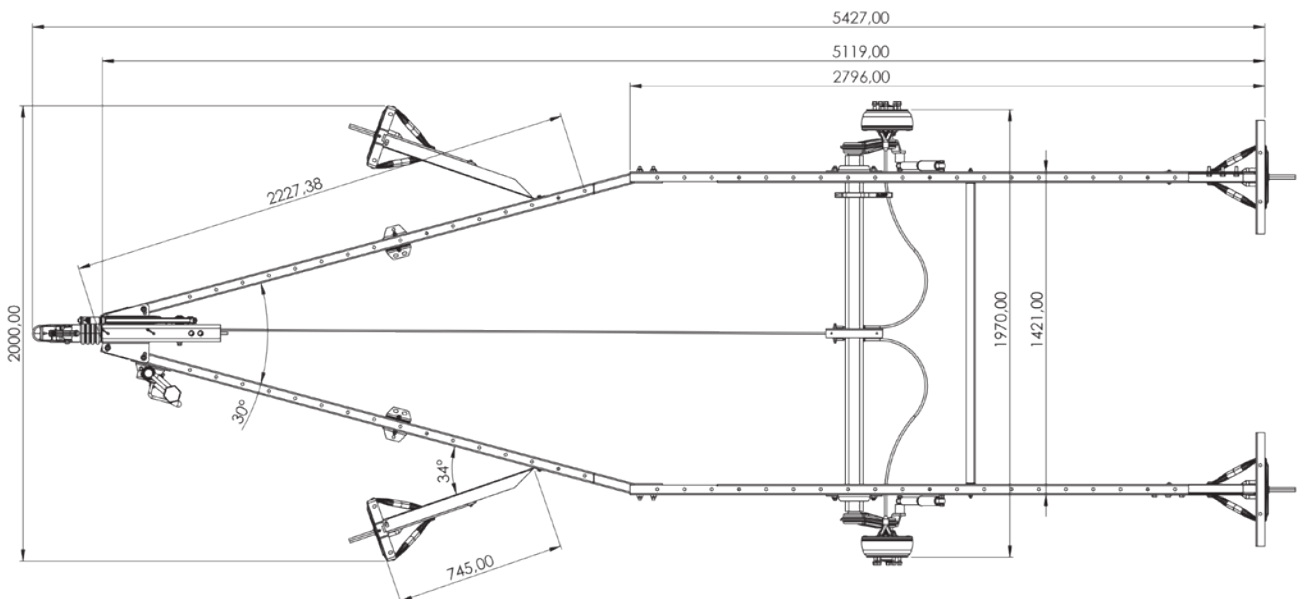

"The product images in the catalog are for promotional purposes. The actual products may vary in design."

NOTES

IMPORTANT

All information, visuals, technical data and dimensions contained in this catalogue are provided solely for promotional and informational purposes.

They do not constitute any commitment or binding obligation.

The reproduction of this catalogue, in whole or in part, including the copying or redrawing of illustrations and the duplication of the catalogue design, is strictly prohibited.

No liability is accepted for any printing errors.

JARUP reserves the right to make changes to product specifications, technical details and dimensions without prior notice.

Hadımköy Mah. Alperay Sok. No: 7
Arnavutköy - İstanbul / Türkiye
Tel: +90 212 485 33 43
www.jarup.com.tr

 jarupofficial  jarupofficial  jarup  jarupofficial